

- WATERMAIN LEGEND:**
- WM — DENOTES EXISTING WATER METER & WATERMAIN
 - FH — DENOTES EXISTING FIRE HYDRANT & WATERMAIN
 - WM — DENOTES EXISTING WATERMAIN & MANHOLE TO BE GRABBED UP & REMOVED
 - WM — DENOTES PROPOSED 100mm Ø HOPE PE100 WATERMAIN
 - SV — DENOTES PROPOSED SLUICE VALVE
 - SAV — DENOTES PROPOSED SCOUR VALVE
 - AV — DENOTES PROPOSED AIR VALVE
 - BB — DENOTES 25mm Ø HOPE PIPE TO IRISH WATER APPROVED BOUNDARY BOX
 - H — DENOTES PROPOSED FIRE HYDRANT
 - D — DENOTES PROPOSED FIRE HYDRANT DUCTILE IRON

GENERAL WATERMAIN NOTES:

1. ALL WATERMANS SHALL BE 100mm Ø HOPE PIPE PE100 WATERMAIN U.N.O.
 2. ALL WATERMANS SHOULD BE LOOPED TO AVOID DEAD ENDS.
 3. ONLY USE ALL FLANGED T'S & ALL FLANGED VALVES.
 4. USE ANTI-CLOCKWISE (LEFT-HAND CLOSING) SLUICE VALVES.
 5. DO NOT USE DUCTILE IRON TAILS – USE FLANGE ADAPTORS WHERE APPLICABLE.
 6. ONLY USE SCREW TYPE HYDRANTS.
 7. THE DEPTH OF THE SLUICE VALVE SPINDLE CAP BELOW FINISHED GROUND LEVEL SHOULD NOT EXCEED 300mm.
 8. THE DEPTH OF THE HYDRANT OUTLET BELOW FINISHED GROUND LEVEL, SHOULD NOT EXCEED 200mm.
 9. AN APPROVED MARKER TAPE CONTAINING A TRACER WIRE, SHOULD BE AFFIXED TO THE TOP SURFACE OF ALL WATERMANS.
 10. NO PIPE, CABLE, CONDUIT OR OTHER SERVICE SHOULD BE LAID LONGITUDINALLY OVER THE LINE OF A WATERMAIN.
 11. ENSURE MARKER PLATES ARE IN PLACE.
 12. ALL WATERMANS SHOULD BE TESTED AT 1.5 TIMES THE WORKING PRESSURE FOR ONE HOUR IN THE PRESENCE OF A MEMBER OF STAFF FROM THE WATERWORKS DEPARTMENT. DETAILS OF TESTING PROCEDURE TO BE DISCUSSED ON SITE WITH CONTRACTOR.
 13. ALL HYDRANTS TO BE PUT IN, IN ACCORDANCE WITH TECHNICAL GUIDANCE DOCUMENT B OF THE BUILDING REGULATIONS 2000/2007 S.S 5.1.6 T.G.D.B & B.5.1 T.S.B.D & THE D.O.E. "RECOMMENDATIONS FOR SITE DEVELOPMENT WORKS FOR HOUSING AREAS".
 14. HYDRANTS TO BE LOCATED IN ACCORDANCE WITH THE FIRE OFFICER'S RECOMMENDATIONS.
 15. PROVIDE THRUST BLOCKS AT ALL CHANGES IN DIRECTION.
 16. ALL CONNECTIONS POINTS TO BUILDING TO BE SERVICED WITH PE-X-100 HOPE PIPE WITH AN SPR RATING OF 11.
 17. ALL WATERMANS, METERS, HYDRANTS & VALVES TO BE INSTALLED, TESTED & CLEANED IN ACCORDANCE WITH IRISH WATER SPECIFICATIONS.
 18. ALL TESTING (PRESSURE CHLORINATION & BACTERIAL) TESTS TO BE IN ACCORDANCE WITH LOCAL AUTHORITIES SPECIFICATION. THE ENGINEER IS TO INSPECT THE PRESSURE TEST AFTER THE WATER CONTROL METRES ARE INSTALLED. ALL HYDRANTS & VALVES ARE TO BE INCLUDED IN THE TEST.
 19. CERTIFICATION AND TESTING (INCLUDING INDEPENDENT THIRD PARTY CERTIFICATION) SHALL BE PROVIDED TO CONFIRM QUALITY ASSURANCE COMPLIANCE. EACH JOINT SHALL BE CLEARLY MARKED WITH THE JOINT LOGGED AUTOMATICALLY ON THE JOINING MACHINE.
 20. A PRINTOUT OF THE JOINT DETAILS, WITH A GPS LOCATION OF EACH JOINT, SHALL BE PROVIDED AND RETAINED FOR QUALITY ASSURANCE PURPOSES.
 21. CONNECTING TO EXISTING MAINS IS TO BE CARRIED OUT BY IRISH WATER OR AN APPROVED IRISH WATER AGENT.
 22. WHEN EXISTING AC WATERMANS ARE PRESENT A SPECIFIC METHOD STATEMENT SHALL BE SUBMITTED TO IRISH WATER PRIOR TO WORKS TAKING PLACE AND SUBJECT TO WRITTEN APPROVAL, DETAILING THE PROTECTION TO BE PUT IN PLACE TO EXISTING MAINS, METHOD OF REMOVAL OF EXISTING AC, METHOD OF DISPOSAL OF EXISTING AC AND METHOD OF CONNECTION TO EXISTING AC.
- FIRE HYDRANT NOTES:**
1. FIRE HYDRANTS TO BE POSITIONED A MINIMUM OF 6m FROM THE PROPOSED BUILDING FOUNDATIONS.
 2. LOCATIONS OF FIRE HYDRANTS AS PER FIRE CERTIFICATE DRAWINGS.
 3. FIRE HYDRANTS TO BE IN ACCORDANCE WITH THE FIRE OFFICER RECOMMENDATIONS.
 4. ALL FIRE HYDRANTS TO BE LOCATED IN ACCORDANCE WITH TECHNICAL GUIDANCE DOCUMENT B OF BUILDING REGULATIONS, 1997 & TECHNICAL GUIDANCE DOCUMENT B OF BUILDING REGULATIONS, 2006 STATUTORY INSTRUMENT 497 OF 1997.
 5. FINAL VERIFICATION SHOULD BE SOUGHT FROM THE FIRE AUTHORITY FOR AGREED LAYOUT OF ALL HYDRANTS & THE NUMBER OF WATER SUPPLY CONNECTIONS TO THE FIRE WATER RING MAIN.

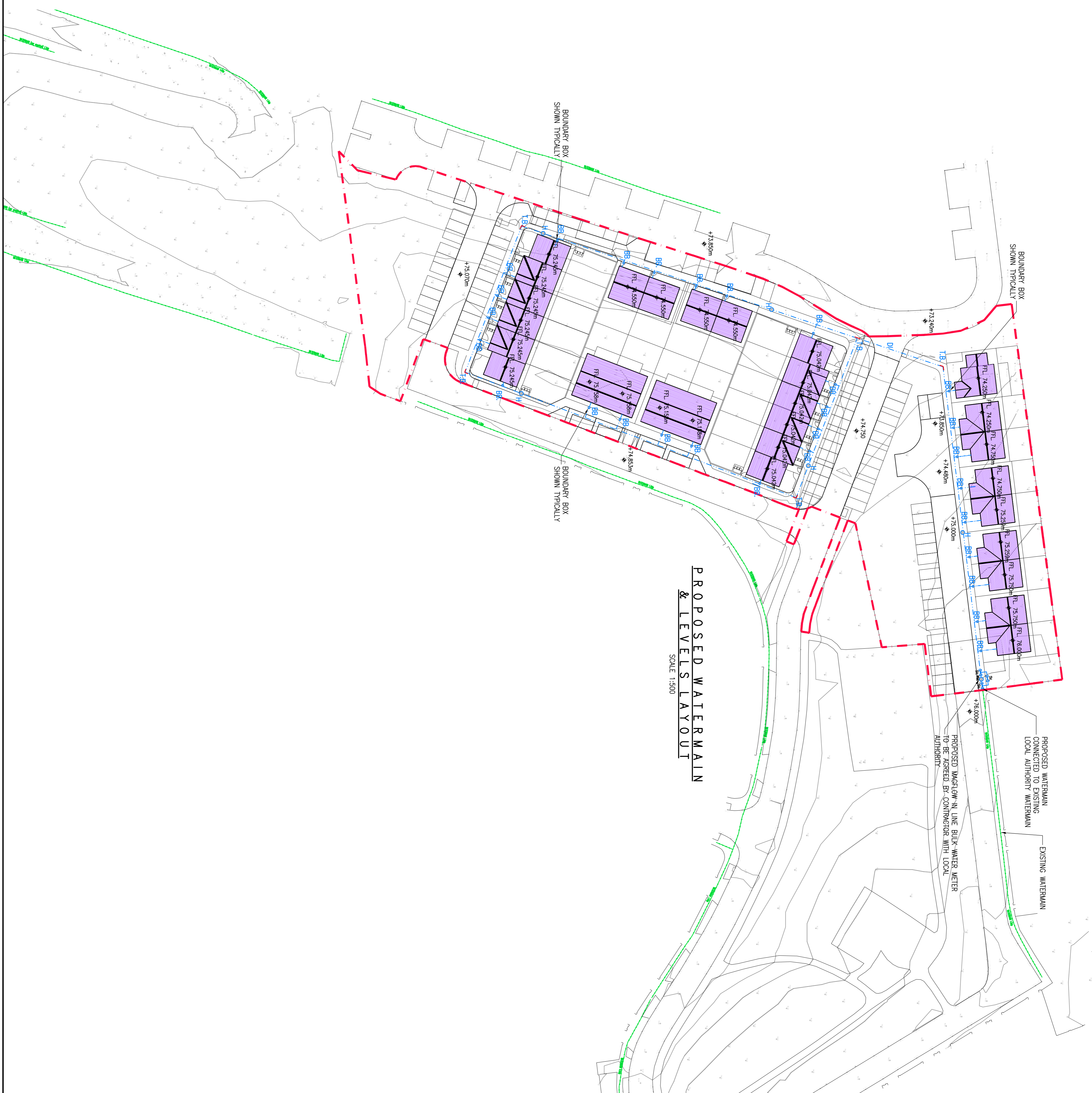

PROPOSED WATERMAIN & LEVELS LAYOUT
SCALE 1:500

NOTES:

- GENERAL NOTES:**
1. THIS DRAWING TO BE READ IN CONJUNCTION WITH ALL RELEVANT ARCHITECTS' SERVICE ENGINEERS DRAWINGS & SPECIFICATIONS.
 2. ALL LEVELS ARE STRUCTURAL UNLESS NOTED OTHERWISE.
 3. ALL WORKS TO BE CARRIED OUT IN ACCORDANCE WITH THE RELEVANT BUILDING REGULATIONS.
 4. DO NOT SCALE – WORK TO FIGURE DIMENSIONS ONLY.

QUALITY
CPD 907/2000
IHM Certified

ENGINEERS IRELAND
cpd ACCREDITED COMPANY

Rev.	Date	Description	Drawn	Checked	Approved
01	24.11.17	PROGRESS ISSUE	CTZ	PR	NR
02	12.01.18	PART 8 ISSUE	CTZ	PR	NR

Client:	KILDARE COUNTY COUNCIL
Job Description:	SOCIAL HOUSING UNITS CASTLETN, SALINS, Co. KILDARE
Stage:	PART 8 ISSUE
Drawn By:	CZUCCO
Checked By:	PRUNCKERON
Approved By:	N.PATTERSON

PROPOSED WATERMAIN & LEVELS LAYOUT

Project No:	16KK042	Drawing Ref:	C-004	Rev:	PL1
Date:	10.10.17	Scale:	A1 – 1:500 / A3 – 1:1000		
Drawn By:	CZUCCO	Checked By:	PRUNCKERON	Approved By:	N.PATTERSON



Hayes Higgins Partnership
Gas House Lane, Kildenny, Co. Wick

051 772421 | 050 722233 | info@hayeshiggins.com
24 Princes Street, Dublin 3 | 011 652321 | 011 652324 | www.hayeshiggins.com